

## IV-VAP 200/210/220/230/240

### HIGH EFFICIENCY MULTICRYSTALLINE PV MODULE



### CHARACTERISTICS OF PEVAFERSA MODULES

Pevafera applies the latest technology and employs qualified professionals for the manufacturing process. The construction of the module is composed of 60 high-efficiency multicrystalline silicon cells, soldered with thin strips of tin and protected by a combination of a 4 mm low-iron tempered glass along with EVA and TEDLAR and a thicker aluminum frame; all of this to ensure a first-class product that assures you a high output and peace of mind.

### APPLICATIONS

- Residential
- Solar Farms
- Industrial
- Large Commercial Installations
- General Solar Applications
- Institutional / Government

### FEATURES

- (+3/-2%) Tolerance Ratio
- 4mm Tempered Glass
- 60 Polycrystalline Silicon Cells
- Tin Soldering
- 46mm aluminum frame
- 25 year warranty
  - 90% - 12 years
  - 80% - 25 years

### I-V CURVE

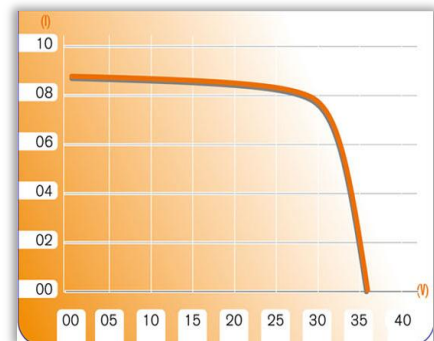

### QUALIFICATIONS

- CENER & AENOR Laboratories
- UNE-EN-61215
- UL 1703
- CEC 400
- TÜV

• PHYSICAL

Unit: mm

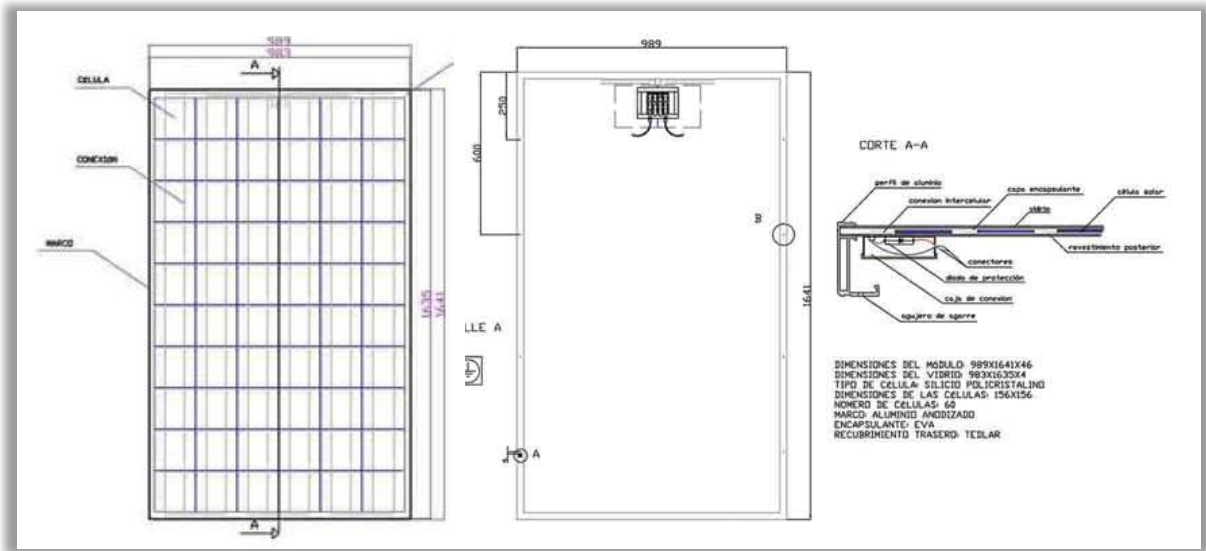

• ELECTRICAL

ELECTRICAL PERFORMANCE UNDER STANDARD TEST CONDITIONS (\*STC)

Model	Pmax (W) (+3/-2%)	Imp (A)	Vmp (V)	Isc (A)	Voc (V)	Isc (mA/K)	Voc (mV/K)	Pmax (mW/K)	^NOCT
IP-VAP 200	200	7.0	28.58	7.74	36.8	+2.11	-144	-.44	47±1°C
IP-VAP 210	210	7.4	29.10	8.0	37.1	+2.11	-144	-.44	47±1°C
IP-VAP 220	220	7.68	29.30	8.2	37.31	+2.11	-144	-.44	47±1°C
IP-VAP 230	230	7.91	29.45	8,38	37.54	+2.11	-144	-.44	47±1°C
IP-VAP 240	240	8.20	29.62	8.61	37.65	+2.11	-144	-.44	47±1°C

\*Values measured in terms of Standard Test Conditions: 1000W/m<sup>2</sup>, 25°C, AM 1.5

^Nominal Operating Cell Temperature: 800W/m<sup>2</sup>, 20°C, AM 1.5

• OTHER

OTHER SPECIFICATIONS

Model	Dimensions [in] (mm)	Weight [lbs] (Kg)	Cells	Operating Temperature	Maximum Voltage
IP-VAP 200	[64.60x38.94x1.91] (1641x989x46)	[51.7] (23,5)	60	-45/+85°C	1000v
IP-VAP 210	[64.60x38.94x1.91] (1641x989x46)	[51.7] (23,5)	60	-45/+85°C	1000v
IP-VAP 220	[64.60x38.94x1.91] (1641x989x46)	[51.7] (23,5)	60	-45/+85°C	1000v
IP-VAP 230	[64.60x38.94x1.91] (1641x989x46)	[51.7] (23,5)	60	-45/+85°C	1000v
IP-VAP 240	[64.60x38.94x1.91] (1641x989x46)	[51.7] (23,5)	60	-45/+85°C	1000v